



Kempinski Hotel
Frankfurt

GRAVENBRUCH

Kempinski Hotel Frankfurt Gravenbruch
Fact Sheet

Kempinski Hotel Frankfurt Gravenbruch
Graf zu Ysenburg und Buedingen Platz 1
63263 Frankfurt/Neu-Isenburg
T: +49 69 389 88 730
F: +49 69 389 88 915
meetings.frankfurt@kempinski.com
kempinski.com/gravenbruch

Kempinski
HOTELIERS SINCE 1897

Facilities & Services

Kempinski Hotel Frankfurt Gravenbruch captivates its guests with charm and character built in the style of an elegant country villa, the former hunting lodge offers a peaceful and tranquil atmosphere. Our guests can enjoy a wide range of leisure facilities also in our Spa. Four restaurants serve regional and international skilled culinary creations.



A new standard for luxury, quality and service in Frankfurt

GENERAL INFORMATION

- Currency: Euro
- Service charge inclusive
- VAT inclusive
- Climate: Central European

ROOMS

- 225 rooms incl. 38 suites
- 218 non-smoking rooms
- 1 handicapped-friendly room
- 1 allergy-friendly room

FACILITIES

- Air conditioning
- Radio, TV, Pay TV, Sky Sport
- Telephone with answering machine
- Laptop size safe
- Minibar

RESTAURANTS/BARS

- Restaurant EssTisch, international cuisine
- Lebanese restaurant Levante
- NIU | Asian Steakhouse
- Torschänke, regional Hessian specialties
- K-Lounge - Lobby bar with fireplace and lake terrace

SMOKERS 100

- Smoker's Lounge, cosy atmosphere for cigar lovers

SPA/SPORT

- 150 sq m heated indoor pool with a starry sky and 100 sq m heated outdoor pool
- generous sunbathing area with direct view over the idyllic lake
- two sunny patios on two floors
- 7 treatment facilities
- 8 saunas incl. a separate female area
- Fitness and training area

HOTELSERVICE

- Concierge service
- Ironing service
- Cleaning
- 24 hour room service
- Daily newspapers
- Business centre
- WiFi internet access (basic speed complimentary)

MEETING/CONVENTION

- 18 function rooms including 2 ballrooms for up to 500 attendees
- Modern conference technology with WiFi (basic speed complimentary)
- Function capacities outside for up to 2,000 attendees
- Various incentive options
- Translation, secretarial and hostess services available upon request

Floor Plans

FIRST FLOOR

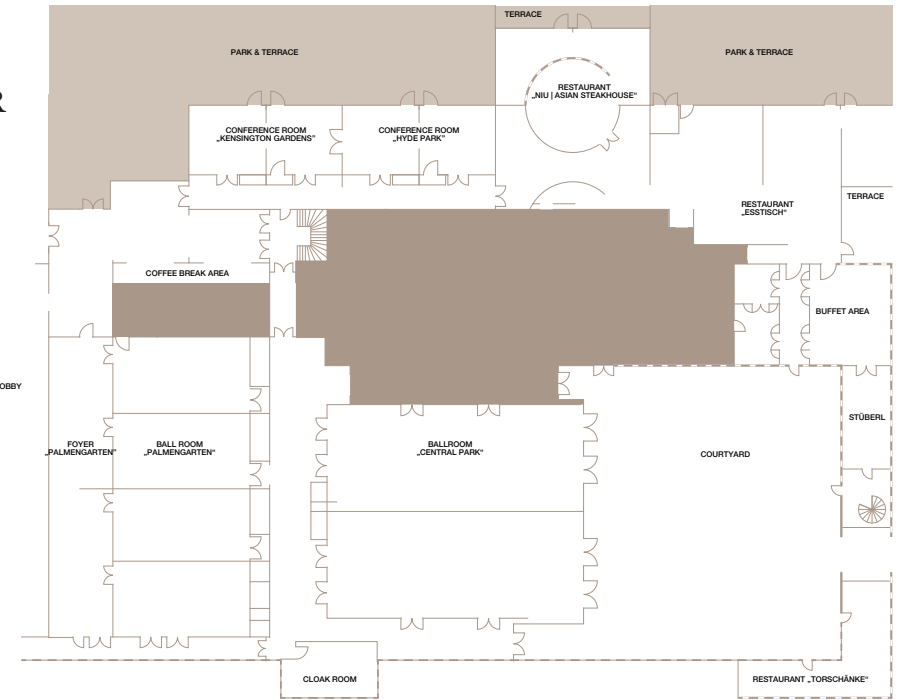

UPPER FLOOR

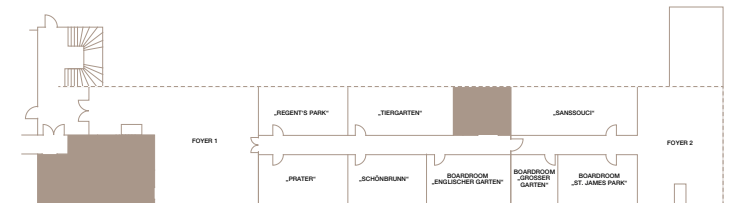

CONFERENCE ROOMS	SIZE (SQM)	THEATRE	CLASSROOM	BANQUET	RECEPTION	BOARDROOM	U-SHAPE
Ballroom "Central Park"	442	500	300	340	500	92	96
Half of Ballroom "Central Park"	220	230	144	150	250	66	66
Ballroom "Palmengarten" with foyer	480	450	280	330	500	50	50
Ballroom "Palmengarten"	330	300	180	240	400	50	50
Half of Ballroom "Palmengarten" with foyer	240	200	100	140	250	30	35
Half of Ballroom "Palmengarten"	165	120	80	100	200	30	35
Ballroom "Palmengarten" 1 section	82	70	40	50	60	30	30
"Kensington Gardens" 2 sections	86	70	45	50	90	30	30
"Kensington Gardens" 1 section	42	30	18	20	35	14	15
"Hyde Park" 2 sections	86	70	45	50	90	30	30
"Hyde Park" 1 section	42	30	18	20	35	14	15
"Sanssouci"	35	24	—	20	30	20	—
"Tiergarten"	32	24	—	20	30	20	—
"Prater"	25	20	—	14	20	14	—
"Schönbrunn"	24	20	—	14	20	14	—
"Regent's Park"	23	20	—	14	20	14	—
Boardroom "Englischer Garten"	23	—	—	—	—	10	—
Boardroom "St. James Park"	22	—	—	—	—	6	—
Boardroom "Großer Garten"	13	—	—	—	—	6	—